

# SPECIFICATION



588

LOA		17.20 m	56' 5"
Hull length		16.70 m	54' 9"
LWL		15.15 m	49' 8"
Beam		5.20 m	17' 1"
Draft			
shallow keel		2.25 m	7' 5"
L-keel, medium		2.60 m	8' 6"
T-keel, deep		2.85 m	9' 4"
Displacement			
shallow keel	approx.	23.00 t	50,706 lbs
L-keel, medium	approx.	22.80 t	50,265 lbs
T-keel, deep	approx.	22.20 t	48,943 lbs
Engine Diesel			
standard	approx.	110 PS	110 hp
option	approx.	150 PS	150 hp
Fuel tank	approx.	520 l	137 gal
Fresh water	approx.	770 l	203 gal
CE Certificate	A - 12		
Design	judel / vrolijk & co		
Interior	HanseYachts Design		

Mast length above WL	approx.	25.85 m	84' 10"
Total sail area	approx.	156.80 m <sup>2</sup>	1,688 sq ft
Main sail			
standard	approx.	92.80 m <sup>2</sup>	999 sq ft
furling	approx.	80.40 m <sup>2</sup>	865 sq ft
Self-tacking jib	approx.	64.00 m <sup>2</sup>	689 sq ft
Reacher	approx.	110.90 m <sup>2</sup>	1,194 sq ft
Gennaker	approx.	246.50 m <sup>2</sup>	2,653 sq ft

All measurements/figures are approximate. Errors and omissions excepted. Specification and material can be changed without notice. Valid from 2022.03.29.

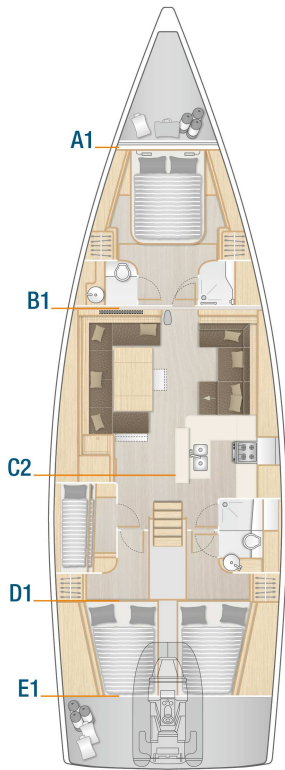
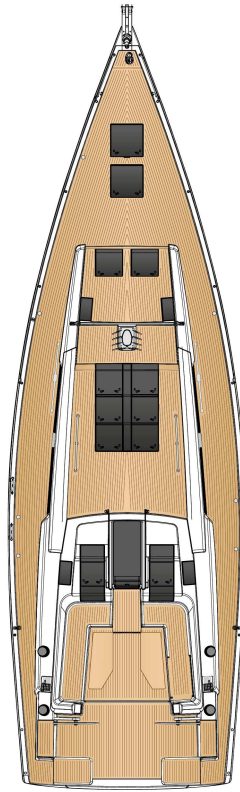

Standard

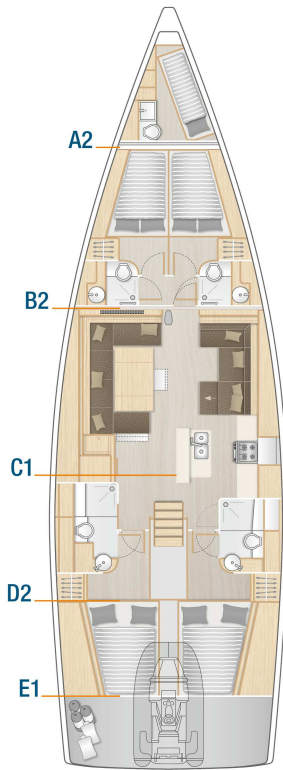

Option

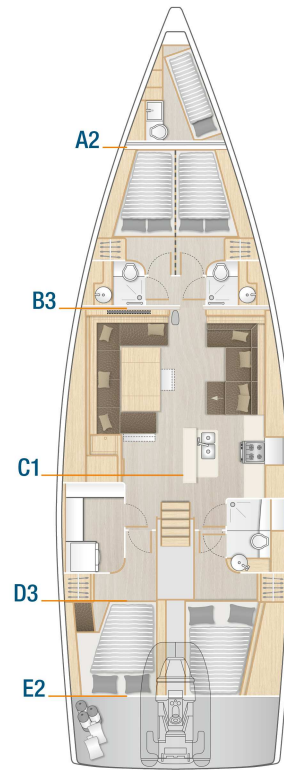

Option

**HULL**

- 12 hull windows (6 each side)
- GRP hull, isophthalic gelcoat, colour: Signal White (RAL9003), 1st layer vinyl ester resin and balsa sandwich laminat
- Waterline and cove line, isophthalic gelcoat, colour: Dark Grey (RAL 7043)

**KEEL**

- L-keel, cast iron, draft: 2.60 m
- GRP rudder with sea-water resistant aluminium shaft and selfaligning bearings

**LAYOUT & INTERIOR**

- A1: Sail locker with extensive storage space
- B1: Master cabin with island double berth, storage space and a head with separate shower stall
- C2: Saloon with full functional L-galley and dining area on stb and lounge area with chart table on port
- D1: Cabin with double bunk bed on port with storage space and dayhead door for head in saloon on stb.
- E1: 2 aft cabins with double berth, storage space and separate head
- 3-burner gas stove with oven, ventilation hood, waste bin, 12 V fridge approx. 140 l, double stainless steel sink with mixing tab
- Interior furniture in high quality marine plywood, Satin Varnish
- Hanse companionway closing system
- Saloon table, fixed
- Silent Master Cabin - cabin noise insulation (only with B1 Layout)
- Worktop in galley - 'Marine Mineral Stone' Anthracite

**WOOD (FURNITURE, FLOORBOARD)**

- Furniture - Mahogany Style, Satin Varnish
- Floorboard - Acacia

**UPHOLSTERY**

- Mattresses for all berths
- Upholstery - Monte Carlo, colour: Cream

**DECK & OUTSIDE EQUIPMENT**

- GRP deck with antislip surface, isophthalic gelcoat, colour: Signal White (RAL 9003), 1st layer vinyl ester resin with balsa sandwich core. Cockpit locker on stb, dinghy garage, stowage for running rigging at helm position, anchor locker at bow.
- Teak on cockpit bottom
- Teak on cockpit benches
- Teak on bathing platform
- Twin wheel steering system
- 2 stainless steel steering wheels with leather cover
- 2 cockpit tables, stainless steel with teak tops
- Pulpit and pushpit, stainless steel
- Railing, incl. stanchions and stainless steel wire with gateway stanchion
- Covered halyards and control lines lead to cockpit helmposition, organizers and jammers, 6 retractable mooring cleats, handrails on coach roof
- 2 LEWMAR 65 ST EVO manual halyard winches
- 2 LEWMAR 55 ST EVO manual secondary winches
- Bathing platform, hydraulic fold-out, remote control and swimming ladder
- Anchor windlass, electrical, 1500 W, with automatic fuse and remote control with chain counter
- Anchor and forestay fitting
- Self tacking jib system
- Mainsheet system
- 12 big and 4 small deck hatches - openable, anchor locker hatch, stowage on coach roof with acrylic glass hatch
- 6 deck coach roof windows - 4 openable, glass next to companionway, portlights in cockpit side for aft-cabins
- Rig, anodized aluminium, keel stepped, with kicker, standing and running rigging and 2 reefs
- Manual jib furler
- QUANTUM Dacron sails - full battened, main and jib

**RIG & SAILS**

### NAVIGATION & INSTRUMENTS

- Illuminated compass at each helm
- Navigation lights - LED

### PROPULSION

- Fuel tank, approx. 520 l
- Engine (Diesel, approx. 110 hp) - shaft drive, 3-blade folding propeller

### EQUIPMENT

- 12 V and 230 V electric system with main panels and 230 V shore power and sockets in cabins and heads
- AGM battery set, capacity: 1x 90 Ah + 2x 160 Ah AGM
- Country Version: EU / AUS
- Battery charger 70 A
- Manual toilet with sea water flush - cabin layout B1
- Manual toilet with sea water flush - cabin layout E1 or E2
- Shower unit in cockpit, warm-/coldwater
- LPG gas system, stowage for 2 gas bottles
- Black water system (appr. 35 l per fwd head, appr. 85 l per aft head) with deck extraction and seacock for head, electric and manual bilge pump
- Fresh water system with electric pump and 40 l hotwater, heated also by main engine
- Fresh water tank, appr. 770 l

### ACCESSORIES

- Mast steps

### SHIPPING & TRANSPORT

- CE - Certificate cat. A - 12 / B - 16 / C - 20
- Owners manual
- EC - Type Examination Certificate